

线圈数据 SOLENOID COIL DATA 08 series

Coil Must Be Installed With Letter Up
安装线圈时，字母必须朝上。

Unit=Millimeters

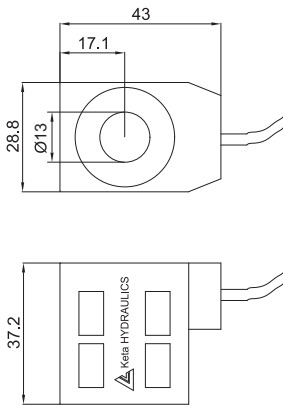

SINGLE LEAD

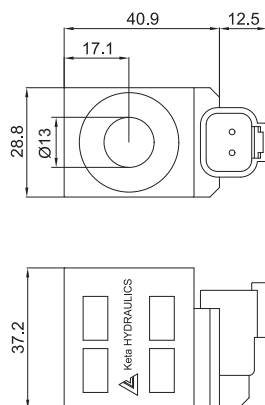

Model:LC2-08-S-*DR(16W)
DEUTSCH CONNECTOR

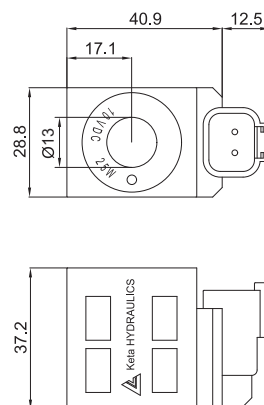

Model:LC9-08-S-*DR(25W)
DEUTSCH CONNECTOR

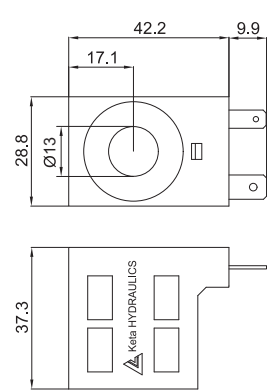

DOUBLE SPADE

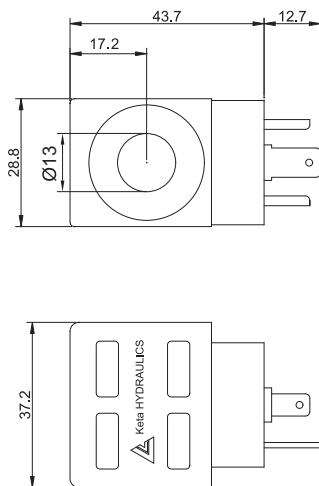

HIRSCHMANN

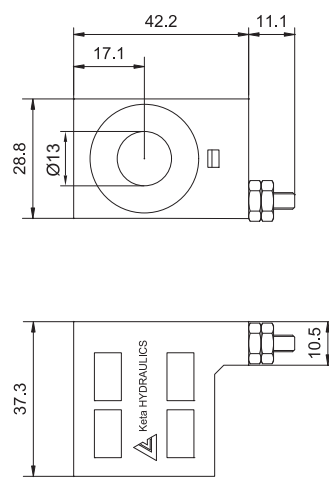

Model:LC2-08-S-*E
Single Stud
8-32 Male Stud
With 2 Brass Nuts

订货代号 TO ORDER

LC2 - 08 - S - * *

- | | |
|---|-------------------------------|
| 1 | 功能
LC2= 电磁线圈 Solenoid Coil |
| 2 | 规格 Size
08=08 规格 |
| 3 | 形状 Shape
S= 方形 Square |

- | | |
|---|-----------------------|
| 4 | 电压 Voltage |
| 1 | 12 VDC RED LEAD 红线 |
| 2 | 24 VDC BLUE LEAD 蓝线 |
| 3 | 110VAC BLACK LEAD 黑线 |
| 4 | 220VAC YELLOW LEAD 黄线 |
| 5 | 10 VDC GRAY LEAD 灰线 |
| 7 | 48 VDC ORANGE LEAD 橙线 |
| 8 | 24 VAC BROWN LEAD 棕线 |

- | | |
|----|--|
| 5 | 线圈连接 Coil Connection |
| D | Double Lead 双线 |
| S | Single Lead 单线 |
| H | Hirschmann 三插 |
| DR | Deutsch Connector(Water-proof Coil)
德意志插座(防水线圈) |
| E | Single Stud 单接线柱 |
| B | Double Spade 双插 |